

## ORDINANCE NO. 06-03-2018

**AN ORDINANCE AMENDING THE ZONING MAP OF SANTAQUIN CITY TO INCLUDE THE RAY'S ADDITION ANNEXATION AREA LOCATED ADJACENT TO THE CURRENT CORPORATE BOUNDARIES OF SANTAQUIN CITY, UTAH**

**WHEREAS**, on April 6, 2018, petitioners who own certain real property adjacent to the City of Santaquin (the "Petitioners"), petitioned to annex the real property described in Exhibit A (the "Property") to the City; and

**WHEREAS**, the Petitioners own the majority of the privately owned real property within the area proposed for annexation; and

**WHEREAS**, all Affected Entities have received notice of the proposed annexation; and

**WHEREAS**, on June 20, 2018, the Santaquin City Council held a public hearing to receive public input concerning the proposed annexation, which public hearing was properly scheduled and noticed in accordance with Utah law; and

**WHEREAS**, the area proposed for annexation lies within the City's current Annexation Policy Plan; and

**WHEREAS**, Santaquin City, Utah desires to amend the Official Zone Map of Santaquin City to include the Property within the City's regulatory boundary.

**NOW, THEREFORE BE IT ORDAINED** by the City Council of Santaquin City, Utah as follows:

**SECTION 1. Official Zone Map Amended.** The Official Zone Map of Santaquin City as adopted by Section 10-7-2 of the Santaquin City Code is hereby amended to include the annexed real property as depicted in Exhibit B.

**SECTION 2. Designation.** The amended area shall be zoned Residential (R-10) as depicted on the zoning map, a copy of which is attached hereto as Exhibit B and incorporated herein by reference.

**SECTION 3. Execution of Documents.** The Mayor is hereby authorized to execute AMENDED ARTICLES OF INCORPORATION OF THE CITY OF SANTAQUIN and a certification of the Santaquin City Council that the legal procedures for annexation have been completed.

**SECTION 4. Posting.** A copy of this ordinance shall be deposited in the office of the Santaquin City Recorder, and on June 20, 2018, the Santaquin City Recorder shall certify that this Ordinance has been posted in three public places within the municipality, as provided in Utah Code Annotated § 10-3-711(1).

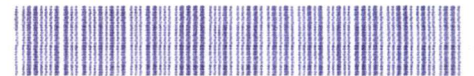

ENT 73181:2018 PG 1 of 4  
JEFFERY SMITH  
UTAH COUNTY RECORDER  
2018 Aug 03 11:09 am FEE 0.00 BY MA  
RECORDED FOR SANTAQUIN CITY CORPORATION

**SECTION 5. Effective Date.** This Ordinance shall take effect on June 20, 2018, and the described Annexation shall be effective upon the certification of the Utah Lt. Governor.

PASSED AND ADOPTED this 20<sup>th</sup> day of June, 2018.

SANTAQUIN CITY

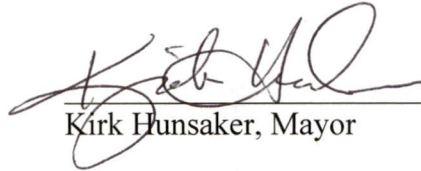
  
Kirk Hunsaker, Mayor



Councilmember Elizabeth Montoya	Voted Aye
Councilmember Lynn Mecham	Voted Absent
Councilmember Keith Broadhead	Voted Aye
Councilmember Nick Miller	Voted Aye
Councilmember Chelsea Rowley	Voted Aye

ATTEST:

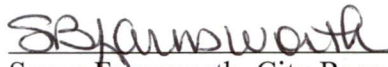
  
Susan Farnsworth, City Recorder



## Exhibit A

### ENGINEER/SURVEYOR'S CERTIFICATE

I HEREBY CERTIFY THAT THIS IS A TRUE AND ACCURATE MAP OF THE TRACT OF LAND TO BE ANNEXED TO SANTAQUIN CITY, UTAH COUNTY, UTAH.

#### BOUNDARY DESCRIPTION

COMMENCING SOUTH 0°08'21" EAST 117.01 FEET ALONG THE QUARTER SECTION LINE AND WEST 126.02 FEET FROM THE NORTH 1/4 CORNER OF SECTION 2, TOWNSHIP 10 SOUTH, RANGE 1 EAST, SALT LAKE BASE MERIDIAN; THENCE AS FOLLOWS:

COURSE	DISTANCE	REMARKS
S 0°55'02" E	494.31'	ALONG THE EXISTING CITY BOUNDARY LINE
N 89°59'35" W	141.94'	ALONG THE EXISTING CITY BOUNDARY LINE
S 0°38'06" W	234.81'	ALONG THE EXISTING CITY BOUNDARY LINE
N 70°45'00" W	347.53'	ALONG THE EXISTING CITY BOUNDARY LINE
N 0°08'04" W	673.43'	
N 2°20'15" E	55.23'	
N 1°13'55" W	262.98'	
E A S T	170.78'	
S 0°29'13" E	140.64'	
E A S T	140.81'	TO THE EXISTING CITY BOUNDARY LINE
S 20°37'00" W	30.83'	ALONG THE EXISTING CITY BOUNDARY LINE
S 27°45'00" W	197.13'	ALONG THE EXISTING CITY BOUNDARY LINE
S 82°43'28" E	261.68'	ALONG THE EXISTING CITY BOUNDARY LINE
		TO THE POINT OF BEGINNING.
		AREA = 8.69 ACRES

BASIS OF BEARING = UTAH COORDINATE BEARINGS, CENTRAL ZONE. S 0°08'21" E BETWEEN THE NORTH 1/4 CORNER AND THE SOUTH 1/4 CORNER OF SECTION 2, T 10 S, R 1 E, S.L.B.& M.

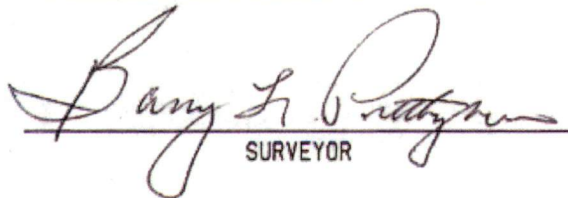
  
 SURVEYOR

March 30, 2018  
 DATE

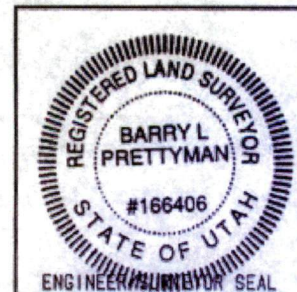



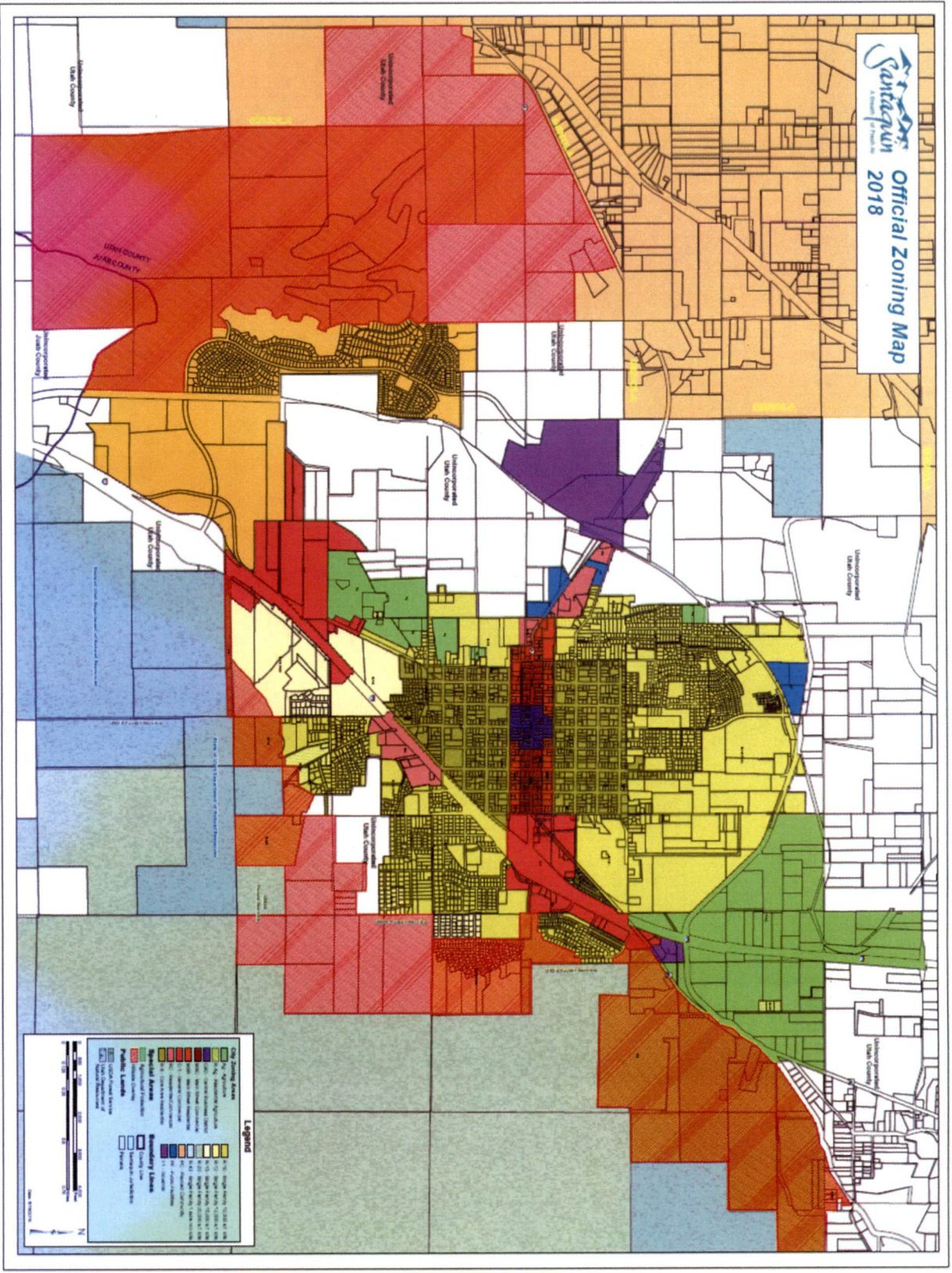

**Exhibit B**